

# 1st floor

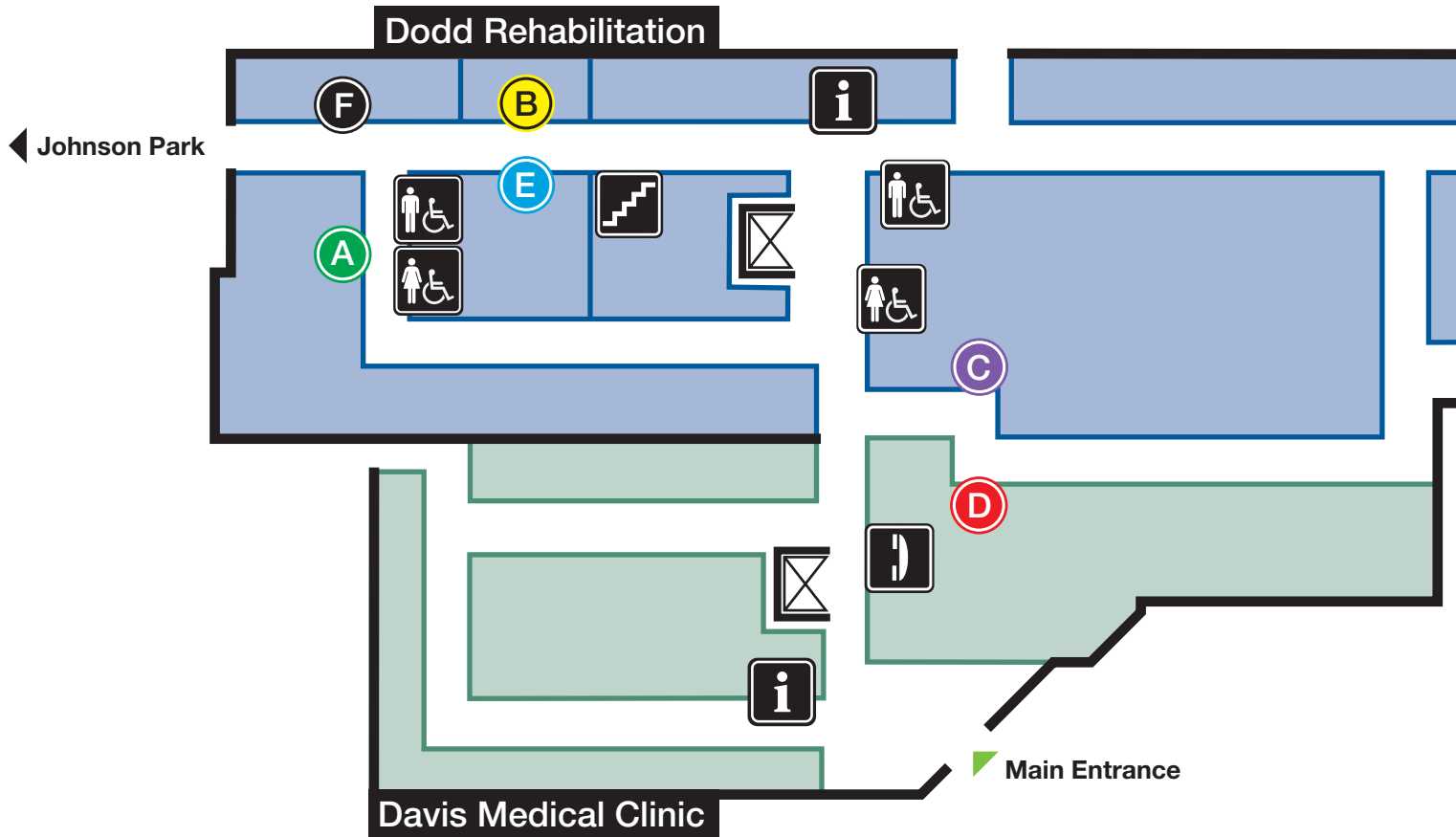

## Map Key

- |  |                              |  |                   |
|--|------------------------------|--|-------------------|
|  | Green Room                   |  | Information Desk  |
|  | Yellow Room                  |  | Women's Restrooms |
|  | Purple Room                  |  | Men's Restrooms   |
|  | Red Gym                      |  | Telephone         |
|  | Blue Gym                     |  | Elevators         |
|  | Independent Living Apartment |  | Stairwell         |



Smoking and the use of tobacco products are not permitted inside or outside of any OSU Medical Center building.