

Finding Your Way to

West Registration, VA/Patient Admission Testing/
Outpatient Laboratory and Occupational Medicine
From The Main Lobby



1492 East Broad Street (Taylor Ave. & E. Broad St.)

Floor 2

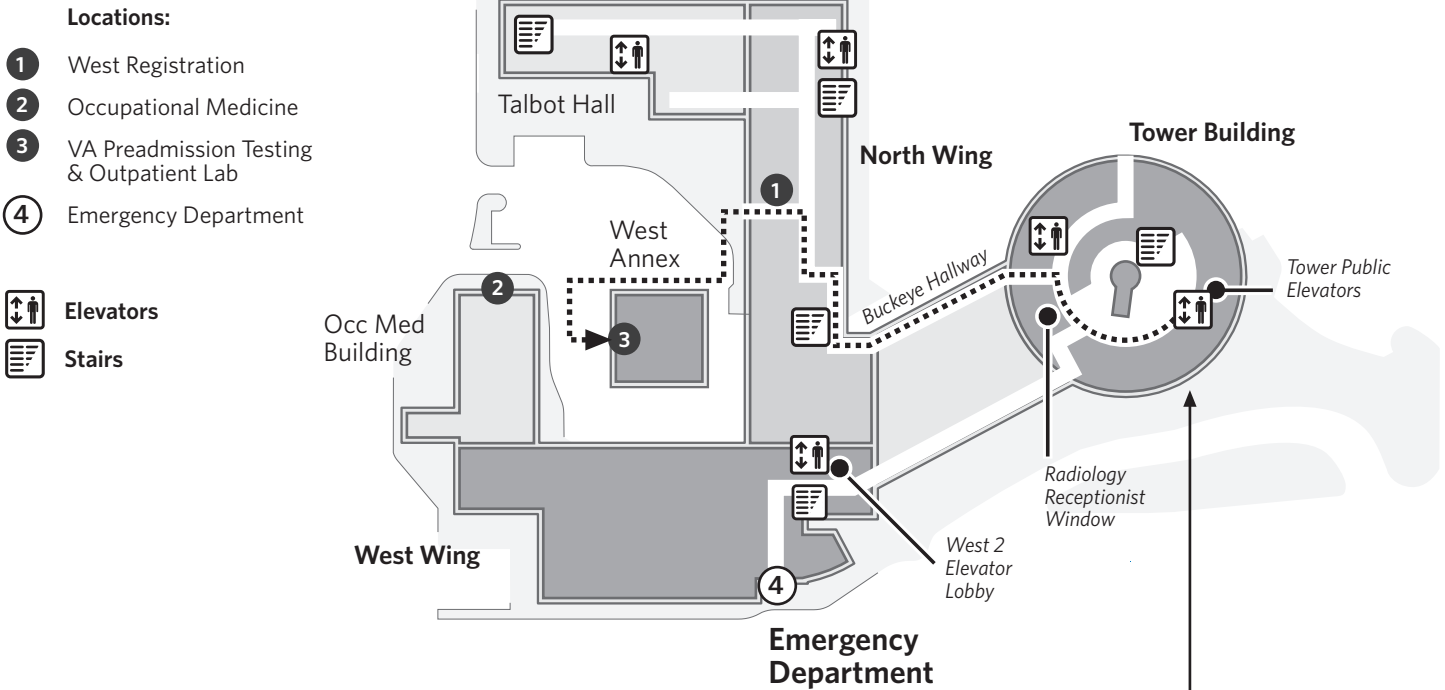

- Take the Tower elevators to the 2nd floor, exit the elevator and turn LEFT.
- Walk past the Radiology Receptionist Window and turn down the hallway with BUCKEYES on the floor.
- Follow the BUCKEYES until they stop.
- Turn LEFT at the last BUCKEYE and West Registration will be on your RIGHT.
- Continue through the double glass doors for the other two locations.
- For the lab, turn immediately to the left at the end of the outdoor awning and walk to the GRAY and MAROON building with the sign that reads:
Veterans Disability Testing Center/
Patient Admission Testing/
Outpatient Laboratory
- Occupational Medicine is the brick building straight ahead.



Smoking and the use of tobacco products are not permitted inside or outside of any OSU Medical Center building.

Updated on June 6, 2009