

# Finding Your Way Around University Hospital East

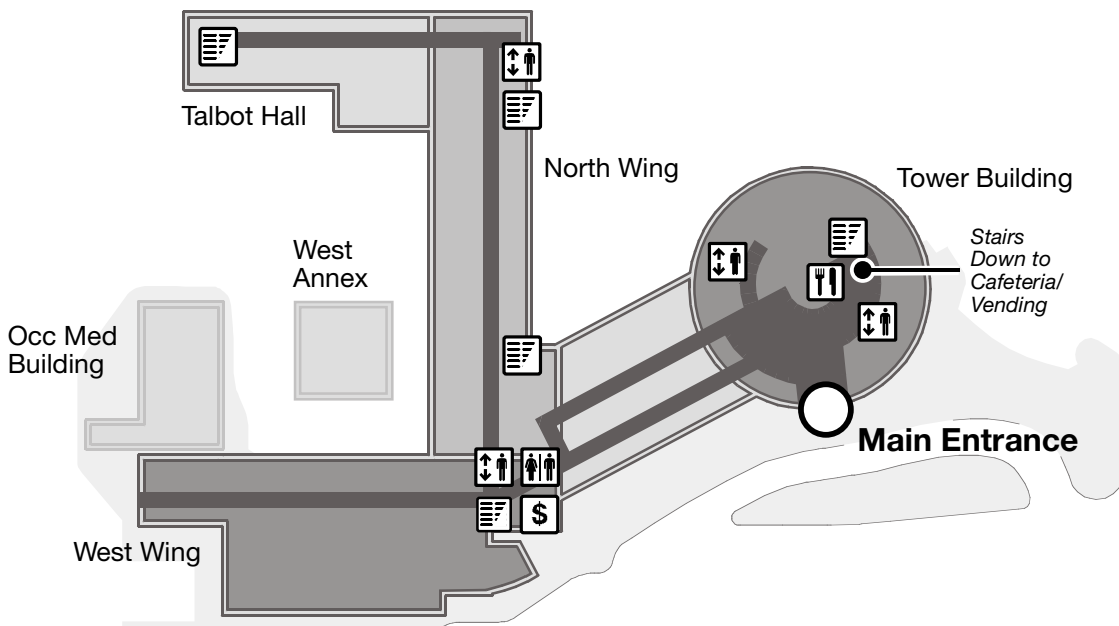

1492 East Broad Street (Taylor Ave. & E. Broad St.)

-  Elevators
-  Stairs
-  Restrooms
-  ATM  
(West Wing/  
Tower Ground Floor)
-  Cafeteria/Vending  
(Tower Ground Floor)



## Floor 1

### Services and Departments

(Walk to listed floor and follow directional signs or ask any staff member for assistance.)

#### Addiction Medicine

Talbot Hall 2

#### Administration

Tower 1

#### Admitting

Tower 1

#### Ambulatory Care Center

Tower 1

#### ATM

West Wing 1  
Tower Ground Floor

#### Cafeteria/Seasons

#### Garden Cafe

Tower Ground floor

#### Cardiac Cath Lab

West Wing 5

#### Cardiac Rehabilitation

West Wing 1

#### Credit Union

North Wing 1

#### CT Scan

(Check-In at West Registration)  
North Wing 2

#### Dialysis

Tower 4

#### EEG/EMG

Talbot 4

#### Emergency

West Wing 2

#### Endoscopy

Tower 1

#### Gift Shop

West Wing 1

#### Human Resources

West Wing 1

#### Hyperbaric Medicine

Tower 9

#### Information Desk

Tower 1

#### Intensive Care Unit (ICU)

West Wing 4

#### JamesCare (Oncology)

*Exam*—Tower 2  
*Chemotherapy & Pharmacy*—  
Tower 9

#### Mammography

North Wing 2

#### Medical Information

**Management (Records)**  
Tower Ground

#### Medical Library

Tower 2

#### Medical Staff Office

Tower 16

#### MRI

North Wing 2

#### Occupational Medicine

Occ. Med. Bldg.—West Entrance

#### Occupational Therapy

North Wing 1

#### Oncology (JamesCare)

Tower 2,9

#### Outpatient Labs Testing

West Annex, West Entrance

#### Pastoral Care

North Wing 3

#### Patient Rooms 301–326

Tower 3

#### Patient Rooms 352–369

West Wing 3

#### Patient Rooms 453–470

West Wing 4 (ICU)

#### Patient Rooms 501–527

Tower 5

#### Patient Rooms N501–N526

North Wing 5

#### Patient Rooms 602–629

Tower 6

#### Patient Rooms 1002–1028

Tower 10

#### Physical Therapy

North Wing 1

#### Pre-Admission Testing

West Annex, West Entrance

#### Pulmonary Rehabilitation

West Wing 1

#### Radiology

Tower 2

#### Registration – Tower

(Admitting)  
Tower 1

#### Registration – West

North Wing 2, West Entrance

#### Respiratory Therapy/EKG

Tower 4

#### Sanctuary

North Wing 3

#### Sleep Disorders Center

(Check-In at West Registration)  
Talbot Hall 4

#### Speech Therapy

North Wing 1

#### Surgery Waiting Area

Tower 4

#### Talbot Classrooms

Talbot Hall 2

#### Vascular Lab

Tower 2

#### Vending Machines/Cafe

Tower Ground

#### Veterans Services (VA)

West Annex, West Entrance

#### Volunteer Services

North Wing 3

#### Wallace Auditorium

Talbot Hall 2

#### Wound Healing Center

Tower 9

# Finding Your Way Around University Hospital East

1492 East Broad Street (Taylor Ave. & E. Broad St.)



- Building Entrances**
- 1 Talbot Hall
  - 2 Wallace Auditorium
  - 3 West Entrance
  - 4 Occupational Medicine
  - 5 VA Preadmission Testing & Outpatient Lab
  - 6 Buckeye Radiation Oncology
  - 7 Emergency
  - 8 Physician Entrance
  - 9 Radiology
  - 10 Ambulance Entrance

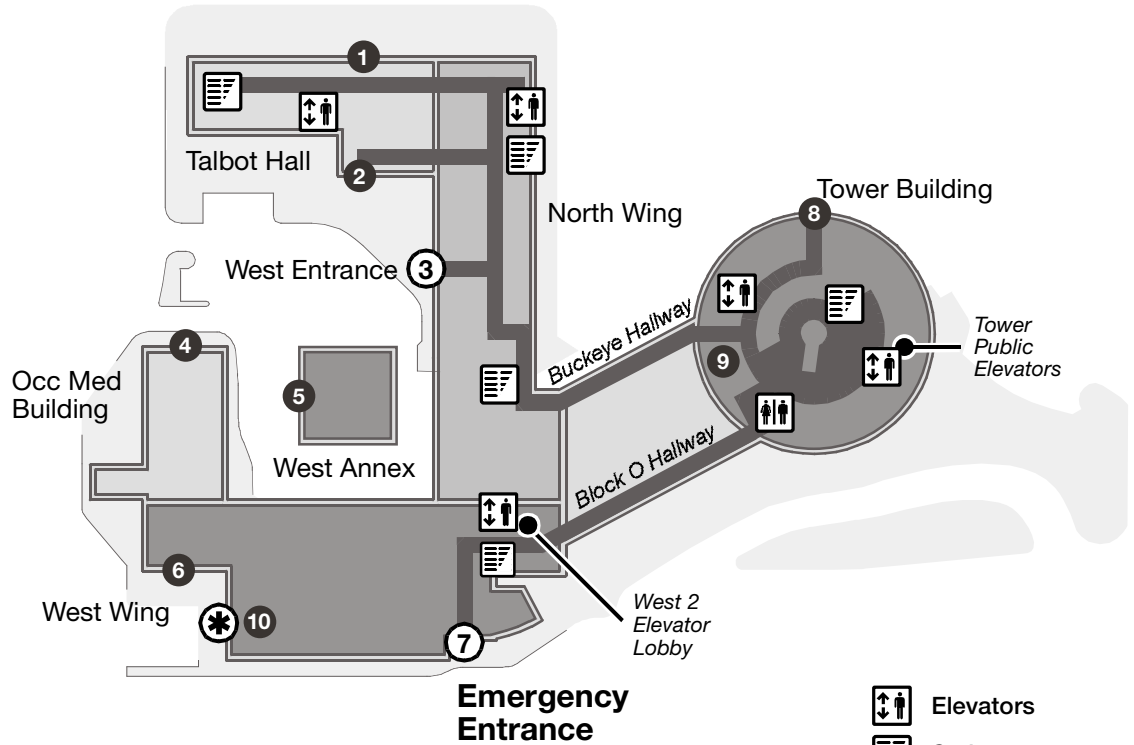

**Emergency Entrance**

- Elevators
- Stairs
- Ambulance Entrance
- Restrooms

## Floor 2

### Services and Departments (See the other side for locations of services and departments)

Physicians in a variety of specialties have clinics or office practices at University Hospital East:

- Addiction Medicine**
- Alternative Medicine**
- Cardiology**
- Digestive Diseases**
- Family Practice**
- General Surgery**
- Hematology/Oncology**
- Internal Medicine**
- Nephrology**
- Neurology**
- Occupational Medicine**
- Orthopedics**
- Pain Management**
- Podiatry**
- Pulmonary Medicine**
- Registration – West**
- Rheumatology**
- Sleep Medicine**
- Vascular Surgery**
- Wound Care/Hyperbaric**

*For current information about physicians with practice offices at University Hospital East, please see the directory at the Tower Elevators, ask at the information desk, or call 257-3160.*

Smoking and the use of tobacco products are not permitted inside or outside of any OSU Medical Center building.

Updated on September 2, 2008